

# Bone Injection Gun Reloading Device RBIG007

## USER MANUAL



# BIG

## SIMPLY SAVING LIVES

11 Galgalei HaPlada St., Herzliya, P.O.B. 12135, Zip 46722, Israel

Tel: +972 - 9 - 9517444 | Fax: +972-9-9517666 | mail@waismed.com | www.waismed.com

Waismed

a PerSys Medical Company





SIMPLY SAVING LIVES

Dear customer,

Waismed is doing its best to supply you with the top quality products at the highest quality levels.

We hope you will find the Reloading System to your satisfaction.

Should you encounter any problem or inquiry please contact us or your local dealer.

[support@waismed.com](mailto:support@waismed.com)

[www.waismed.com](http://www.waismed.com)

### **NOTES AND PRECAUTIONS:**

- ! The spring used in the reloadable devices is weaker than the sterile BIG, in order to enable easier reloading of the device.
- ! The Reloading Device is intended for use only with the Demo BIG supplied with it.
- ! The use of the Reloading Device is only for authorized personnel who were trained to use and reload the BIG.
- ① For additional information and safety issues refer to the included CD-ROM.
- ① The training BIG is a non sterile device, and therefore should only be used with the attached Foam or the WMTLeg (training leg).
- ① The manufacturer recommends the Reloading Device to be used no more than 50 times.
- ① The manufacturer recommends the Demo Reloadable Device to be used no more than 50 times.

11 Galgalei HaPlada St., Herzliya, P.O.B. 12135, Zip 46722, Israel

Tel: +972 - 9 - 9517444 | Fax: +972-9-9517666 | mail@waismed.com | www.waismed.com





# BIG

SIMPLY SAVING LIVES

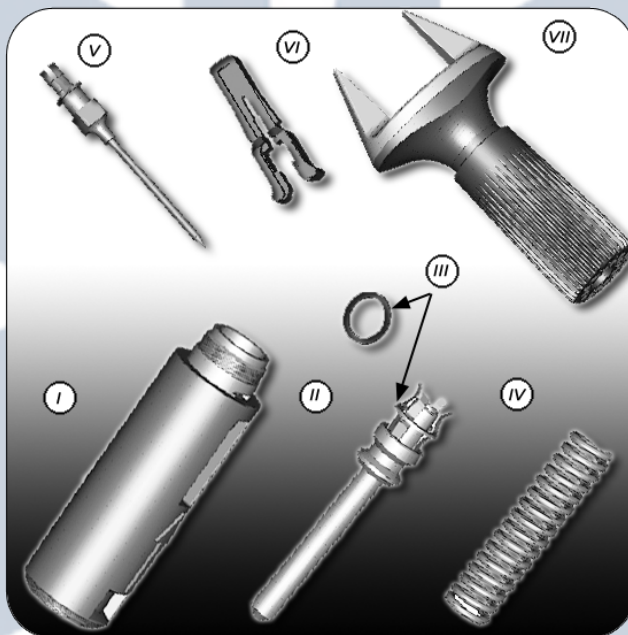

In order to reload the BIG you will need the following parts:

- I. **Rear Body**
- II. **Piston**
- III. **Washer (Ring)**
- IV. **Spring**
- V. **Needle**
- VI. **Safety Latch**
- VII. **Front Body**

11 Galgalei HaPlada St., Herzliya, P.O.B. 12135, Zip 46722, Israel

Tel: +972 - 9 - 9517444 | Fax: +972-9-9517666 | mail@waismed.com | www.waismed.com

Waismed

a PerSys Medical Company



# BIG

SIMPLY SAVING LIVES

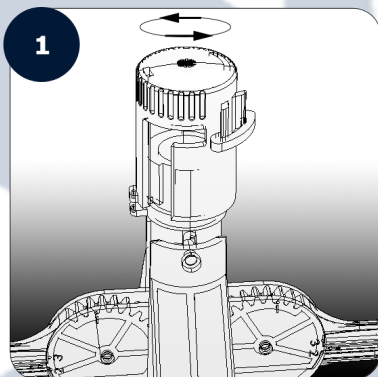

Position the **Reloading Device** with Waismed sticker facing you.

The handles should be in **Position 2**.

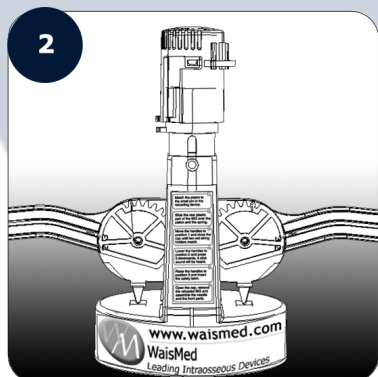

Remove the **cap** at the top of the **Reloading Device**. Twisting it counter clockwise and pull it **up**.



# \* BiG

SIMPLY SAVING LIVES

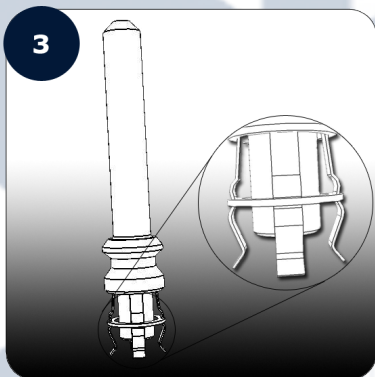

Move the **Washer (Ring) (III)** on top of the **Piston (II)** to the small groove on the **Needle-Gripping Prongs**.

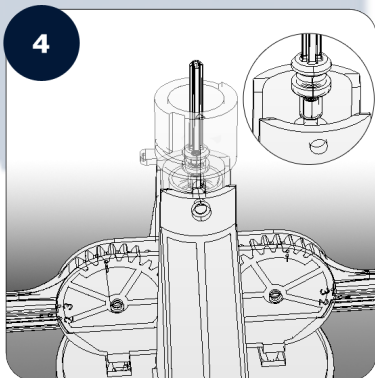

Match the **Piston (II)** to the small **Pin** inside the **Reloading Device**.

11 Galgalei HaPlada St., Herzliya, P.O.B. 12135, Zip 46722, Israel

Tel: +972 - 9 - 9517444 | Fax: +972-9-9517666 | mail@waismed.com | www.waismed.com

Waismed

a PerSys Medical Company



# \* BiG

SIMPLY SAVING LIVES

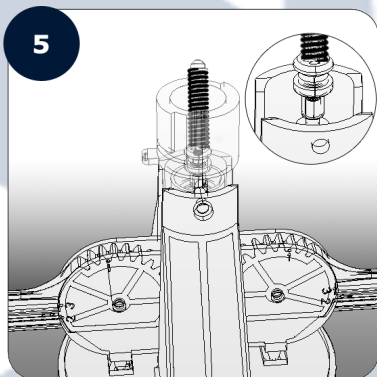

Slide the **spring (IV)** over the **Piston (II)**.

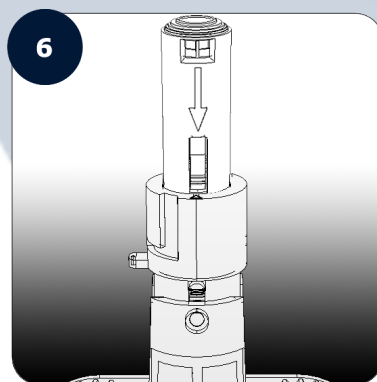

Slide the **Rear Body of the B.I.G. (I)** over the **Piston (II)** and **Spring (IV)**; make sure that the **Bolder Raised Arrow** matches the **groove** on the back of the device and the **Shallower Arrow** is pointing at the **red line** on the front of the device.

*! Arrows should be pointed downwards.*



# \* BIG

SIMPLY SAVING LIVES

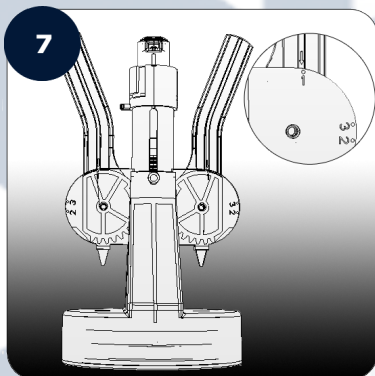

Move the **handles** to **Position 1**.

With your fingers, press the top of the **BIG** and press it downwards. You should feel the **spring's** resistance.

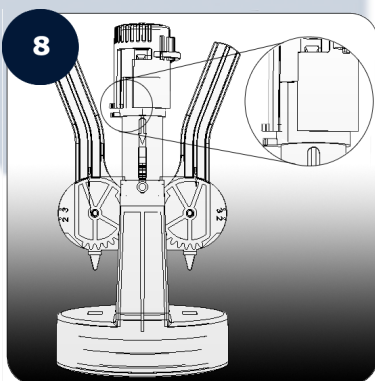

While holding the **handles** in **Position 1**, close the **cap** by pushing it downwards and twisting it clockwise until the two **red string holders** match.



# \* BIG

SIMPLY SAVING LIVES

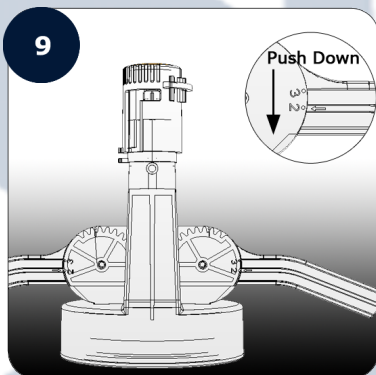

Lower the **handles** to **Position 2** and press it downwards until a click sound is heard.

*! The handles base and the device base should touch one another.*

*! Do not lean on the far side of the handles as they might break.*

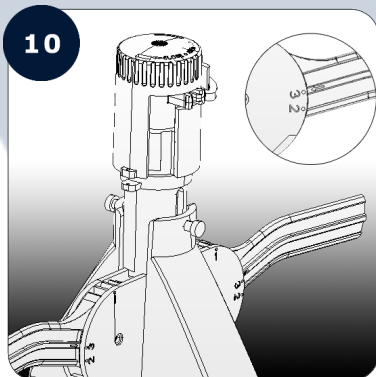

Raise the **handles** to **Position 3**.

*! Caution!*

*The spring (IV) is now loaded and great care should be taken while handling the BIG.*

*! Do not try to remove the BIG without inserting the safety latch (VI) (step 12).*



# BIG

SIMPLY SAVING LIVES

11

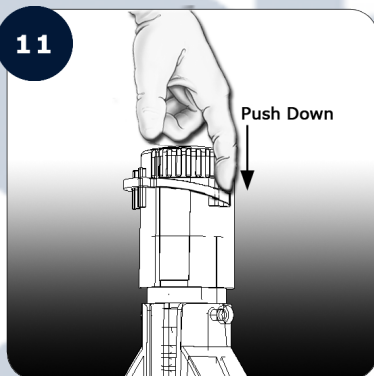

Lower the **red clip** on the **cap's back** with your finger until you can insert the **Safety Latch (IV)**.

12

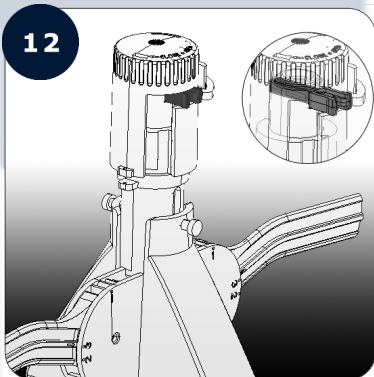

Insert the **safety latch (VI)**.

*! Make sure the safety latch (VI) is firmly in place and could be seen through the small hole on the other side of the cap.*



# BIG

SIMPLY SAVING LIVES

13

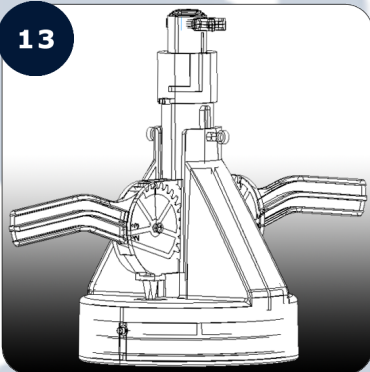

Remove the **Cap** by twisting it counter-clockwise and pulling it **up**.

14

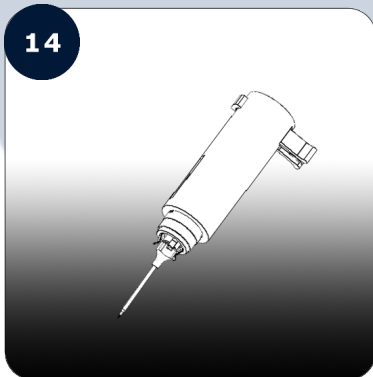

Remove the **BIG** from the **cap** and place the **Needle (V)** hub into the **Needle Gripping Prongs**, until the **Needle (V)** is firmly and securely held in place. (A click sound will be heard).

*! Do not try to open the cap without inserting the safety latch (VI) first.*

*! For safety issues; when placing the needle (V) hub into prongs, make sure that the sharp end of the needle is not directed at any person.*



# \* BIG

SIMPLY SAVING LIVES

15

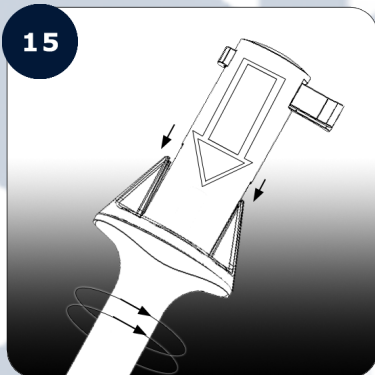

Close the **Front Body (VII)** of the **BIG** by screwing it onto the **Rear Body (I)**.

*! Never take out the safety Latch (VI) when the device is loaded.*

*! Never point the BIG and/or the needle at a person.*

For further information, instructional movies, presentations and article please go to [www.waismed.com](http://www.waismed.com)

## LOOKING FOR A TRAINING?

Just go to [www.waismed.com](http://www.waismed.com) and click the 'Online Training' icon.

One of our representatives will contact you within 48 hours and coordinate an online training session free of charge!

11 Galgalei HaPlada St., Herzliya, P.O.B. 12135, Zip 46722, Israel

Tel: +972 - 9 - 9517444 | Fax: +972-9-9517666 | [mail@waismed.com](mailto:mail@waismed.com) | [www.waismed.com](http://www.waismed.com)







# **BiG**

SIMPLY SAVING LIVES